



CASEMENT/AWNING/PICTURE INSTALLATION INSTRUCTIONS

IMPORTANT INFORMATION FOR INSTALLER/HOMEOWNER

Before You Begin:

- Read these instructions thoroughly before beginning to install your window.
- The determination of the suitability and compatibility of all building components and the design and installation of flashing and sealing systems are the responsibility of the architect, contractor, installer and/or the manufacturer of the building exterior specified for the home.
- The contractor and window/door installer are ultimately responsible for best practices and compliance to all local building codes.
- All rough openings for windows and doors must be flashed properly so as to properly manage moisture and prevent entry of water into the wall cavity.
- Materials used must meet all codes and be compatible with building exterior and window surfaces.
- All sealants must meet grade NS class 25 per ASTM C920. Sealant must be compatible with building exterior and window surfaces.
- Always provide a copy of instructions to the building owner.
- Failure to follow these procedures will void your FarNorth™ Windows & Doors warranty coverage.

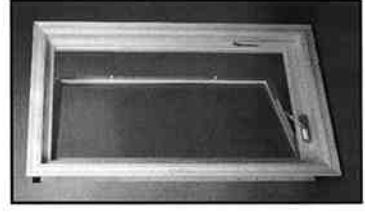

10/04

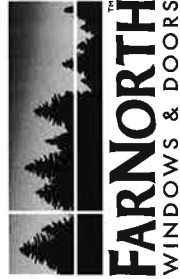

11100 Jefferson Highway North • Champlin, MN 55316
(763) 433-3340 • www.schererbros.com

FarNorth™ Windows & Doors is a division of Scherer Bros. Lumber Co.

By installing this product, you accept the terms and conditions of the warranty as stated on the attached product label.

CASEMENT/AWNING/PICTURE WINDOW

BASED ON REQUIRED DRAIN PLANE & SIDING TYPE, CHOOSE 1 OF THE FOLLOWING 2 METHODS

Air Barrier Method 1 - Windows installed after application of Weather Resistant Barrier (WRB).

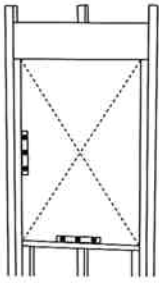

STEP 1

Rough opening needs to be 1" wider and 3/4" higher than the outside measurement of the unit. Check to make sure rough opening is level, square and plumb. A sloped sill pan method is recommended. To accommodate add appropriate additional length to the rough opening height.

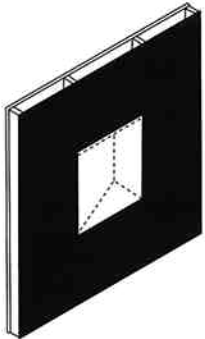

STEP 2

Make a modified "I-cut" in weather-resistant barrier (WRB) at rough opening by first cutting up from bottom corners at 45 degree angle toward the center of opening, then continuing up to header. Finally, cut across entire width of window opening at head.

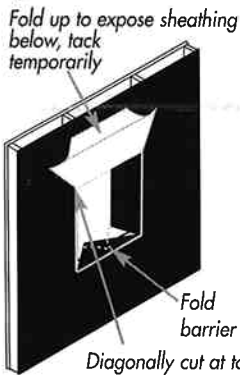

STEP 3

Wrap WRB at jambs and sill onto the entire width of the rough opening and fasten. **DO NOT fasten at head.**

Make diagonal cuts in WRB up and away from top corners of rough opening. Lift WRB head flap up and temporarily fasten to sheathing so as not to interfere with window installation.

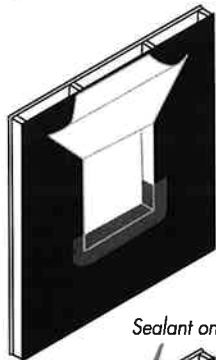

STEP 4

Install flexible self-adhesive flashing membrane to create a sill pan flashing up the side 4" - 6" of the rough opening.

NOTE: Non-flexible self-adhesive flashing can also be used to form a sill pan flashing; be careful to seal all seams.

Sealant on top and sides only

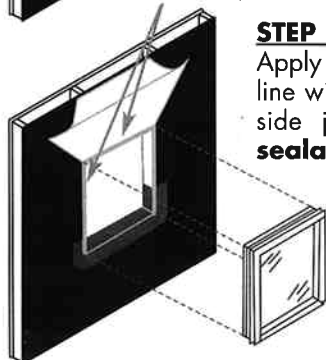

STEP 5

Apply continuous 3/8" bead of sealant in line with nail holes/fasteners at head and side jambs only. **DO NOT apply sealant along sill.**

Center unit into opening. Nail upper corners of nailing fin to secure unit into opening.

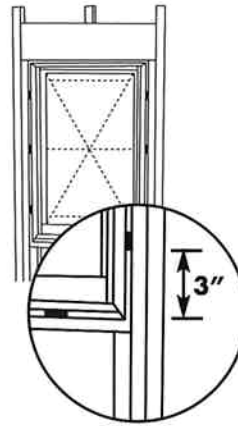

STEP 6

- Level and shim sill.
- Make sure reveal between sash and frame is uniform at the outside of the window.
- Square and plumb all jambs before shimming unit into opening. First, place shims 3" from top and bottom of the window, then shim 16" around the remainder of the frame. **DO NOT over shim.**
- Complete nailing of sides, head and sill of nailing fin with 2" galvanized roof nails in each pre-punched hole.

STEP 7

Apply foam corner pads. Caulk around corner pads 4" in both directions.

Always apply metal drip cap to wood units. Local codes may also require you to apply a metal drip cap over existing vinyl drip cap on clad units.

When insulating rough opening, **low expanding foam** can be used with fiberglass insulation. Apply 1" - 2" of foam behind each nailing flange except at the sill. To prevent damming of the sill, insulate only immediately below the extension jamb. **DO NOT over insulate.**

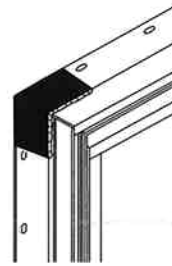

STEP 8

Apply self-adhesive flashing to jambs of unit, wrapping it onto window frame to entirely cover flange/frame joint.

NOTE: A fillet bead of sealant may alternatively be applied to entirely cover flange/frame joint.

Next, apply self-adhesive flashing to head of window unit in the same manner.

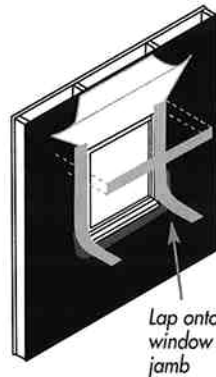

Lap onto window jamb

STEP 9

Fold WRB flap at head down over head jamb flashing and secure in place with tape. **DO NOT tape along the entire window head**, as this may trap any incidental water that gets behind the WRB.

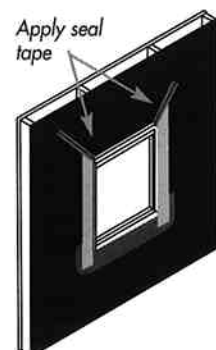

Apply seal tape

WINDOW INSTALLATION INSTRUCTIONS

5 OF INSTALLATION, THEN READ THE NEXT PAGE FOR CAULKING AND FINISHING INSTRUCTIONS.

Building Paper Method 2 - Windows installed before application of Weather Resistant Barrier (WRB).

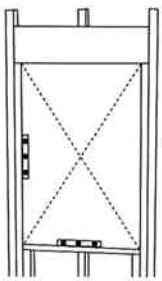

STEP 1

Rough opening needs to be 1" wider and 3/4" higher than the outside measurement of the unit. Check to make sure rough opening is level, square and plumb. A sloped sill pan method is recommended. To accommodate add appropriate additional length to the rough opening height.

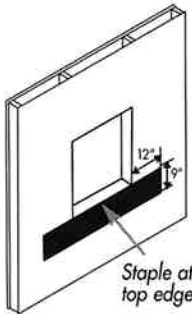

STEP 2

Cut a strip of weather-resistant barrier (WRB) that is 24" longer than the width of the rough opening. Center and apply flush with the bottom of the rough opening. Staple at top edge only.

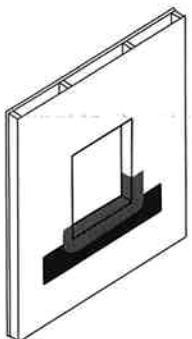

STEP 3

Install flexible self-adhesive flashing membrane to create a sill pan flashing up the side 4" - 6" of the rough opening.

NOTE: Non-flexible self-adhesive flashing can also be used to form a sill pan flashing; be careful to seal all seams.

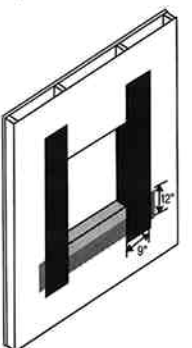

STEP 4

Cut two 13" strips of WRB approx. 24" longer than the rough opening height. Notch ends of strips and wrap them to cover the rough opening side jambs and fold them out onto sheathing. Staple in place.

STEP 5

Apply continuous 3/8" bead of sealant in line with nail holes/fasteners at head and side jambs only. **DO NOT apply sealant along sill flange.**

Center unit into opening. Nail upper corners of nailing fin to secure unit into opening.

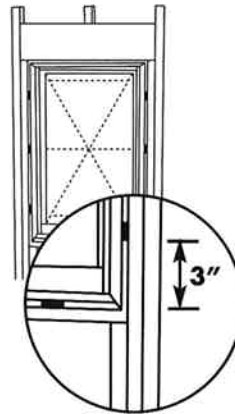
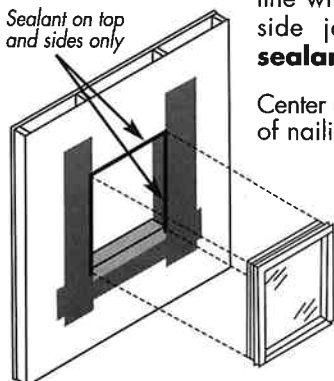

STEP 6

- Level and shim sill.
- Make sure reveal between sash and frame is uniform at the outside of the window.
- Square and plumb all jambs before shimming unit into opening. First, place shims 3" from top and bottom of the window, then shim 16" around the remainder of the frame. **DO NOT over shim.**
- Complete nailing of sides, head and sill of nailing fin with 2" galvanized roof nails in each pre-punched hole.

STEP 7

Apply foam corner pads. Caulk around corner pads 4" in both directions.

Always apply metal drip cap to wood units. Local codes may also require you to apply a metal drip cap over existing vinyl drip cap on clad units.

When insulating rough opening, **low expanding foam** can be used with fiberglass insulation. Apply 1" - 2" of foam behind each nailing flange except at the sill. To prevent damming of the sill, insulate only immediately below the extension jamb. **DO NOT over insulate.**

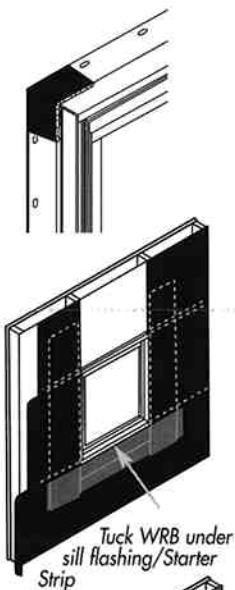

STEP 8

Tuck main layers of WRB under sill starter strip from Step 2. At jambs, install WRB over nail flanges, butting against the window frame. Install courses of WRB beyond top of window but not directly over the window.

STEP 9

Apply self-adhesive flashing to jambs of unit, wrapping it onto window frame to entirely cover flange/frame joint.

NOTE: A fillet bead of sealant may alternatively be applied to entirely cover flange/frame joint.

Next, apply self-adhesive flashing to head of window unit in the same manner.

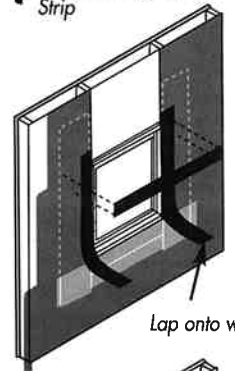

STEP 10

Apply WRB over head of window.

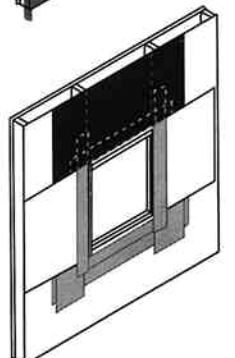

CAULKING PROCEDURES

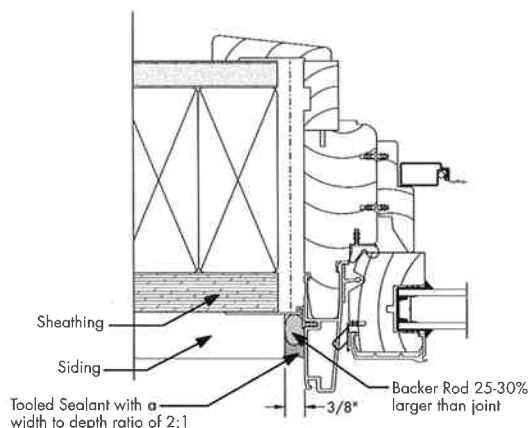

Always follow the siding manufacturer's application instructions and local building code requirements.

When applying siding or exterior cladding, allow for a space between the window frame and siding for sealant along the sides and bottom of the window. In this space, apply backer rod to assure for a properly sealed joint. **Do NOT seal at the head of the window** so any incidental water is allowed to weep out over the drip cap.

Be sure to properly seal joint between window frame and J channel at the top corners of the unit.

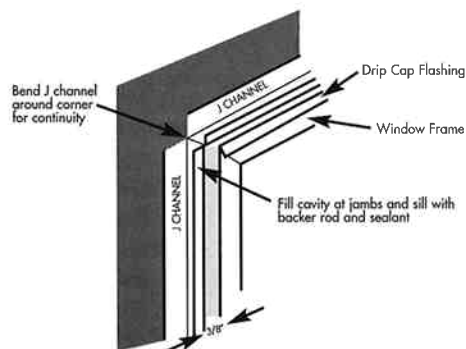

The flashing details offered in this document were derived from a variety of sources including The American Society for Testing and Materials Standard E2112 "Standard Practice for Installation of Exterior Windows, Doors, and Skylights", the American Architectural Manufacturers Association's (AAMA) "Installation Masters Installer Training Program" manual, and the Minnesota Lath and Plaster Bureau's "Stucco in Residential Construction" publication.

PAINTING & STAINING

When preparing to finish the exterior of wood windows, make sure to fill all nail and staple holes with wood filler. Finish paint on primed or bare wood windows must be applied immediately following installation. Make sure to apply to all exposed wood surfaces.

When you are applying paint or other finish to windows, it is extremely important that you do not paint the weatherstripping; vinyl, plastic or other non-wood parts; sills; pile weatherstripping; hardware, handles, rollers, etc. Paints, stains and varnishes contain solvents which cause plastics or vinyls to dry out and become brittle. Once they become brittle, they will need to be replaced.

Before finishing, remove any marks or imperfections by sanding with a 220 or 320 grit sandpaper. Then clean the surfaces and allow to dry thoroughly before applying your finish.

EXTERIOR FINISHING - Use only a high quality exterior paint. Paint with sash or panels open or removed and keep open until dry. Apply one coat of primer and two coats of paint. We do not recommend staining or use of clear coat finishes on exterior surfaces.

INTERIOR FINISHING - Use only a high quality oil base or latex paint. Paint with sash or panels open or removed and keep open until dry. Apply one coat of primer and two coats of paint. Make sure to finish entire unit, including top, bottom and sides. For staining: follow stain manufacturer's instructions. Softwoods, such as pine, may take stains unevenly. To help avoid a blotchy look, apply a pre-stain wood conditioner before staining. Apply stain, allow to dry, then apply 2 coats of sealant. For more information on staining go to: www.sherwin-williams.com.

GENERAL CARE & MAINTENANCE

CLADDING - To clean the exterior aluminum cladding, use mild soap and water. Make sure you do not use abrasive cleaners. If you have a stain that does not come clean from the soap and water, you can try using mineral spirits. To maintain the shine of your cladding, use a non-abrasive car wax.

SCREENS - To clean your screen, remove it from the window and wash it with mild soap and water, or use your vacuum cleaner and attachment.

CAULKING - It is the responsibility of the homeowner to inspect and maintain all caulking joints at and around all exterior openings.

GLASS CLEANING & PRESERVE™

Careless and improper cleaning of your glass can permanently damage it. Avoid cleaning your glass in direct sunlight as spotting may occur.

To clean the glass use a mild, non-abrasive cleaning solution with a soft cloth. NEVER scrape the glass with metal blades or knives as this will permanently scratch the glass and void your warranty. For other information on glass cleaning go to: www.glasswebsite.com

PRESERVE™ - Preserve is applied to both the interior and exterior surfaces of the product. It is a temporary, protective film, which safeguards glass from the materials and elements that can damage your window on the job site. To remove, simply pull the corner slowly. Remove the film no later than one year after purchase.